

SUMMARY OF WEIGHTS [ESTIMATED]			
S.NO.	DESCRIPTION	TONNES	MATERIAL
1	UNDERFRAME SECTIONS	2.38 t	IS:2062 Fe 410 Cu WA
2	TORSION BOX WITH BOLSTER	2.24 t	IS:2062 Fe 410 Cu WA
3	SUPERSTRUCTURE	6.32 t	IS:2062 Fe 410 Cu WA
4	C.B.C. COMPLETE WITH UNCOUPLING GEAR (NON-TRANSITION)	1.32 t	STANDARD IRS
5	BOGIE	10.80 t	CASNUB 22-HS MOD-1
6	30"x30" DISCHARGE GATES & HATCHES	0.72 t	
7	AIR BRAKE WITH RIGGING COMPLETE	1.62 t	GRADUATED RELEASE TYPE WITH LSD
8	CAT WALK AND LADDER	0.54 t	IS:2062 Fe 410 WA
9	OTHERS	0.50 t	IS:2062 Fe 410 Cu WA
10	ESTIMATED TARE	26.44 t	
11	CARRYING CAPACITY	60.84 t	
12	GROSS LOAD	87.28 t	
13	AXLE LOAD	21.82 t	
14	GROSS VOLUME	84.28 Cum	
15	LOADABLE VOLUME	81.76 Cum	* SEE NOTE
16	TRACK LOADING DENSITY	6.82 t/m	
17	C.G. FROM RAIL LEVEL (EMPTY)	1130 mm	
18	C.G. FROM RAIL LEVEL (LOADED)	2182 mm	

*LOADABLE VOLUME HAS BEEN ESTIMATED AFTER LEAVING 100mm FROM TOP OF THE ROOF INSIDE.

SALIENT FEATURES

- BOGIES:-**
TWO AXLE CAST STEEL BOGIE TYPE "CASNUB 22-HS MOD-1" WITH AN AXLE LOAD OF 22.9 t IS FITTED WITH THE FOLLOWING:-
(I) SPRING PLANK,
(II) LONG TRAVEL HELICAL SPRINGS,
(III) LOAD PROPORTIONATE FRICTION DAMPING DEVICE,
(IV) TAPER ROLLER CARTRIDGE BEARINGS WITH NARROW JAW ADAPTERS,
(V) ELASTOMERIC PADS,
(VI) CONSTANT CONTACT POLYMER TYPE SIDE BEARERS,
(VII) WHEELS OF ONE METRE DIA. ON TREAD WITH 2 METRE WHEEL BASE.
- BRAKES:-**
SINGLE PIPE GRADUATED RELEASE AIR BRAKE SYSTEM FITTED WITH LOAD SENSING DEVICE.
- COUPLER:-**
STANDARD AUTOMATIC CENTRE BUFFER COUPLER OF KNUCKLE TYPE NON-TRANSITION
- PROVISION FOR LOADING AND UNLOADING:-**
(I) CONTINUOUS OPENING WITH HATCH COVER AND PROPER SEALING
(II) TWO NOS. GRAVITY DISCHARGE GATES AT BOTTOM FOR UNLOADING.
(III) END TO END CATWALK ON EITHER SIDE OF HATCH.
(IV) LADDER AT BOTH ENDS.
- OTHER PARTICULARS:-**
(I) STUB CENTRE SILL - STANDARD 'Z' SECTION
(II) FABRICATED SOLEBAR
(III) SHEAR PLATE WITH TORSION BOX TO TAKE LONGITUDINAL LOAD.
- INFRINGEMENT:-**
DESIGN OF THE WAGON IS WELL WITHIN THE MAXIMUM MOVING DIMENSION OF REVISED SCHEDULE OF DIMENSIONS 2004 DIAGRAM No. 1D 1676mm GAUGE (B.G.) EXCEPT THE HATCHED PORTION.

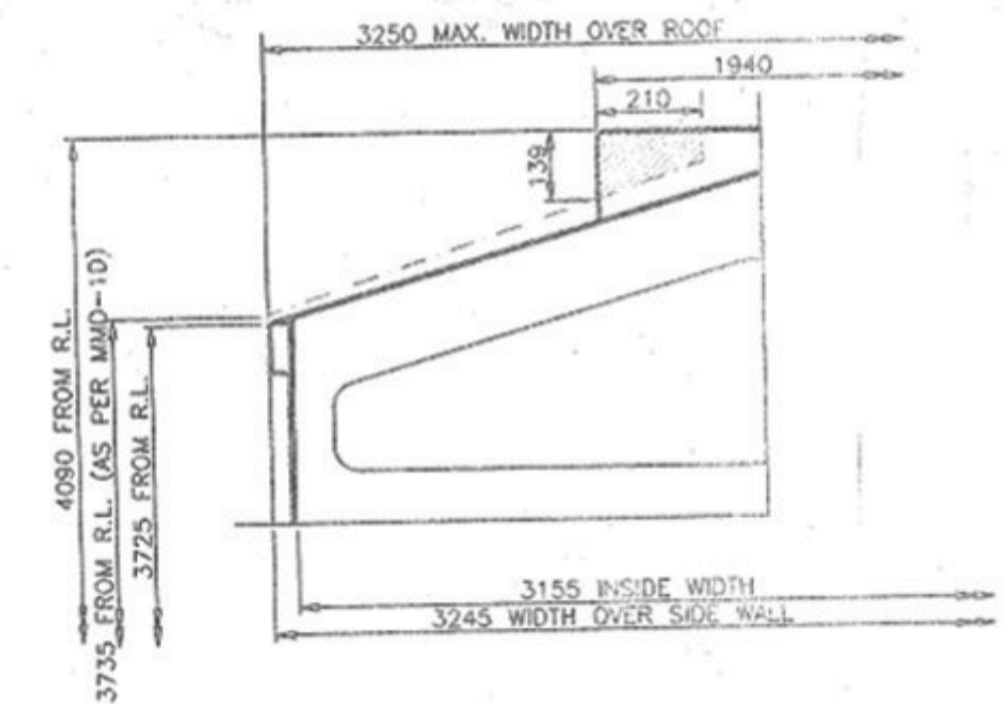

DETAIL AT 'X'
INFRINGEMENT DETAILS

⑤	④	③	②	①
		DRAWING REVISED & REDRAWN.	11/03	9/07
		MM/CS/BFG	DATA OF C.G. ADDED	-24-
		RLY BD	CAT WALK WIDTH MODIFIED	-52-
ALT.	ITEM	AUTHY.	DESCRIPTION	CKD. DATE

SUPERSEDED BY :		BOGIE COVERED HOPPER WAGON FOR FOOD GRAIN TYPE 'BCBFG'	
SCALE :			
P	D Kamillo	01/07	
C	Keswani	01/07	
D	S. Khore	01/07	
T			
J.S.			
B.G. RITES LTD.		GROUP	
		RSD-6337-052	